



ACCOMMODATION/ MAINTENANCE VESSEL

Year Built	: 2009
Class	: ABS
Notation	: * A1E "Offshore Support Vessel" * AMS
Type	: Offshore Support/ Maintenance Vessel



DIMENSION

Length Overall	: 78.00 m
Length Waterline	: 73.98 m
LBP	: 70.55 m
Breadth Moulded	: 20.00 m
Depth Moulded	: 6.50 m
Draft Moulded	: 4.80 m
GRT	: 3,404 MT
NRT	: 1,021 MT
Deadweight	: 2000 MT

PERFORMANCE

Design Speed	: 11.5 Knots
Type of fuel	: Marine Gas Oil

CARGO CAPACITIES

Deck Cargo	: 800 MT
Deck Strength	: 7.5 MT/ m ²
Clear Deck Area	: 500 m ²
Fuel Oil	: 925 m ³
Fresh Water	: 800 m ³
Drill Water/ Ballast	: 1690 m ³
Mud	: 400 m ³
Freezer	: 25 m ³ (-18° C)
Chiller	: 25 m ³ (+14° C)

PROPULSION SYSTEM

Main Engine	: 2 x 2610 BHP Yanmar 2EY26
Main Generator	: 3 x 750 kW Cummins
Emergency Generator	: 2 x 99 kW Cummins
Bow Thruster	: 1 x 10 MT
Steering Gear	: Electro-hydraulic type
Propellers	: 2 x FPP with Kort Nozzle
Rudders	: 2 x Conventional Rudder

DECK EQUIPMENT

Capstan	: 2 x 5 MT @ 15 m/min
Tugger Winch	: 2 x 10 MT @ 15 m/min
4-point Mooring Winch	: 4 x 40 MT @ 10 m/min
Work Crane	: 1 x 30 MT SWL @ 14 m radius (SWH – 0.6 m)

FIRE FIGHTING EQUIPMENT

External	
FiFi	: Fire Fighting ½ FiFi
Fire pump	: 1 x 1200 m ³ /h @ 14 bar
Fire monitor	: 2 x 600 m ³ /h @ 12 bar inlet pressure

Internal	
Fixed System in E/R:	CO2 system in engine room
Fire Detection System	: All living spaces and Engine Room
Fixed Auto Water Sprinkler System	: All living spaces include store, workshop etc.

OTHERS

Rescue Zone	: Port & Stbd Side
Water Maker	: 2 x 15 MT/ day

DISCHARGE RATES

Fuel Oil Pump	: 1 x 200 m ³ / hr @ 75 m head
Fresh Water Pump	: 1 x 150 m ³ / hr @ 75 m head
Drill Water Pump	: 1 x 150 m ³ / hr @ 75 m head
Mud Pump	: 2 x 70 m ³ / hr @ 85 m head

NAVIGATIONAL /COMMUNICATION

GMDSS	: SAILOR Area A1 + A2 + A3
MF/ HF Transceiver	: 1 x SAILOR
GPS	: 1 x KODEN KGP-920
SART	: 2 x SAILOR SART II
Inmarsat C	: 1 x SAILOR TT-3000E
Satellite EPIRB	: 1 x SAILOR SE406-II
Navtex Receiver	: 1 x JRC NCR-333
Radars	: 2 x JRC JMA5312
Echo Sounder	: 1 x JRC JFE-380
Gyrocompass	: 1 x Anschuetz STD22
Autopilot	: 1 x Anschuetz
Portable VHF	: 3 x McMurdo R2
Weather Fax	: 1 x Furuno
Speed Log	: 1 x Furuno
Magnetic Compass	: 1 x Lilley & Gille MK2000
AIS	: 1 x JOTRON TR2500
LRIT	: SAILOR

ACCOMMODATIONS

Berths	: 2 x 1 berth cabin = 2 5 x 2 berths cabin = 10 42 x 4 berths cabin = 168
Total	: 180 berths
Hospital	: 1 x 2 berths = 2
All cabins are fully air-conditioned	

LIFE SAVING APPLIANCE

Search Lights	: 3 x 2000 W
Floodlights	: 5 x 1000 W (sodium halogen type)
Liferafts	: 18 x 25 men
Life Boat	: 2 x 85 men
Lifebuoys	: 12 pcs
Life jackets	: 198 pcs
Immersion Suits	: 183 pcs
Parachute Distress Signal	: 12 Units
EEBD	: 8 Units

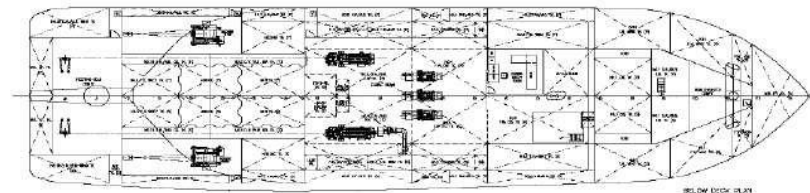
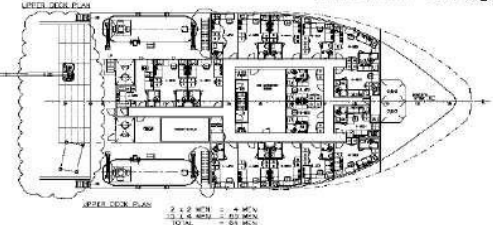
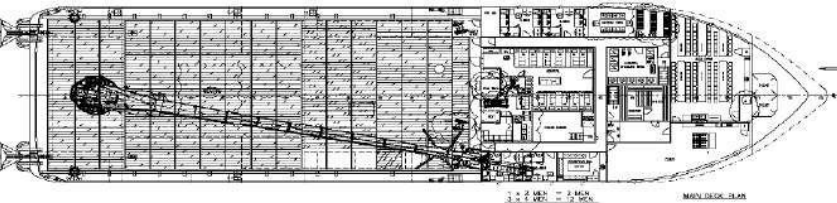
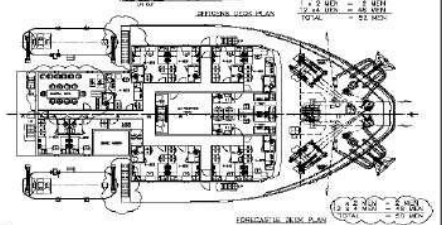
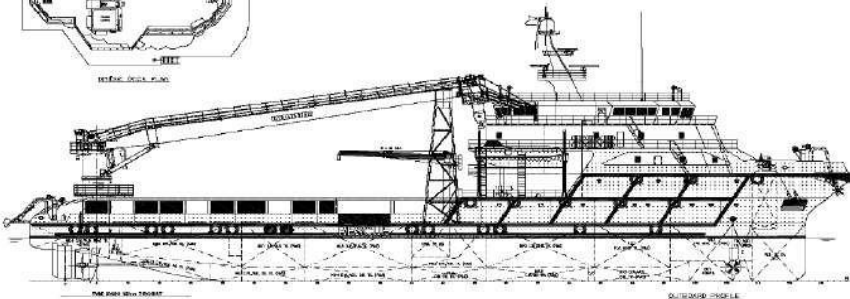
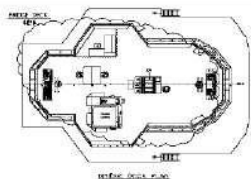

PRINCIPAL DIMENSIONS

LENGTH (O.A.)	26 600 M
LENGTH (P.P.)	20 225 M
BEAM (MAX.)	2 500 M
DEPTH (MAX.)	2 500 M
DEPTH (DECK)	4 800 M
P.A.C. D.	5 700 M
FRESH WATER	8 000 M ³
SWELL WATER / W.B.	10 000 M ³
W.P. (NO TOW)	400 M ³
W.P. (NO TOW)	200 M ³
CLEAN DECK AREA	680 M ²
DECK CARGO DECK (LOADING) (T/M ²)	800 M ²
WAT. T. (DISP. 1000 TONS)	2 600 G (DISP.)
W.P. D. (DISP. 1000 TONS)	150 M ³
COMPLEMENT	120 MEN



BUREAU
VERITAS

VeriSTAR Info Survey Status

Vessel Type: Special service

Gross Tonnage: 3404

Date of build: 20 Oct 2009

Regulatory Information

New requirements applicable

MARPOL, Annex VI as amended by resolution MEPC.328(76) entered into force on 1 November 2022. From 1 January 2023 it is mandatory for ships of 400 GT and above (new and existing) to calculate their attained Energy Efficiency Existing Ship Index (EEXI) to measure their energy efficiency. New regulation 5.4.7 of MARPOL Annex VI requires that verification of the ship's attained EEXI, in accordance with the requirements in regulations 23 and 25, shall take place at the first IAPP annual, intermediate or renewal survey or the IEE initial survey, whichever is the first, on or after 1 January 2023. Following satisfactory survey, the revised International Energy Efficiency (IEE) Certificate and its supplement will be re-issued.

It is reminded that the Marine Environment Protection Committee of the IMO, at its 71st meeting (July 2017) agreed on the phase in of compliance with the standard described in regulation D-2 (i.e. installation of BWMS) for Existing ships (Regulations B-3). For "existing ships" (ships constructed prior to 8 September 2017), the IOPP renewal survey to be taken into account on or after 8 September 2017 as the start of the phase-in of conducting Ballast Water Management that at least meets the standard described in regulation D-2 is: - FIRST RENEWAL SURVEY IF: 1. this survey is completed on or after 8 September 2019, or 2. a renewal survey was completed after 8 September 2014 but prior to 8 September 2017 - SECOND RENEWAL SURVEY IF: the 1st renewal survey following the entry into force of the BWM Convention is completed prior to 8 September 2019, provided that a renewal survey (i.e. IOPP renewal survey) was NOT completed on or after 8 September 2014 but prior to 8 September 2017. NB: Existing Ships which are not subject to hold an IOPP certificate shall comply with the standard described in regulation D-2 from the date decided by the Administration, but not later than 8 September 2024.

1-Year Survey Planner

Class Surveys

Survey name	Jan	Feb	Mar	Apr	May	Jun	Jul	Aug	Sep	Oct	Nov	Dec	Jan	Feb	Mar
Hull - Annual	S														
Annual survey of structure	S														
Hull - Intermediate	S														
Machinery - Annual	S														

Statutory Surveys

Survey name	Jan	Feb	Mar	Apr	May	Jun	Jul	Aug	Sep	Oct	Nov	Dec	Jan	Feb	Mar
Load Line - Annual	S														
Saf. Construction - Annual	S														
Saf. Construction - intermediate															
Saf. Equipment - Annual															
Saf. Equipment - Periodical	S														
Launching Appliances - Annual Test	S														
Saf. Radio - Periodical	S														
SPS 2008 <= 60p Safety Const. Annu (...)	S														
SPS 2008 <= 60p Safety Const. Inte (...)															
SPS 2008 <= 60p Safety Equipment A (...)															
SPS 2008 <= 60p Safety Equip. Peri (...)	S														
SPS 2008 <= 60p Safety Radio Perio (...)	S														
Launching App. - Annual Test	S														
Dangerous Goods - Annual	S														
Oil Pollution - Annual															
Oil Pollution - Intermediate	S														
Air Pollution - Annual															
Air Pollution - Intermediate	S														
Ballast Water Mngt - Annual															
Ballast Water Mngt - Intermediate	S														
ILO 152 Cargo Gear - Annual															

Statutory Audits / Inspections

Audit / Inspection name	Jan	Feb	Mar	Apr	May	Jun	Jul	Aug	Sep	Oct	Nov	Dec	Jan	Feb	Mar
ISM - Intermediate															
ISPS - Intermediate															
MLC Intermediate inspection															

Planned Inspection Items

Statutory Items

SOLAS Safety Radio Harmonized

Item Nr	Date	Type	VS*	Inspection Item	Due Date	Action Date
KLP0/2022/J5231-SR10	15 Jun 2022	Obs	1	GPS unit software to be updated according to maker specification.	 15 Aug 2022	10 Aug 2022.

* Verification Scheme:

- 1 Inspection/test/report by authorized person and confirmation of action taken through www.veristar.com by the indicated due date. Documentary evidence to be kept on board. Verification/confirmation by BV Surveyor during next attendance onboard
- 2 Inspection by BV Surveyor by due date

Legend:

 Recommendation overdue	 Observation overdue
 Recommendation overdue in less than 1 month	 Observation overdue in less than 1 month
 Recommendation with limit date in less than 3 months	 Observation with limit date in less than 3 months
 Recommendation with action taken – To be confirmed	 Observation with action taken – To be confirmed
 Conditions of Class overdue	
 Conditions of Class overdue in less than 1 month	
 Conditions of Class with limit date in less than 3 months	
 Conditions of Class with action taken – To be confirmed	

ISM Code Non-Conformities

None

ISPS Code Non-Conformities

None

MLC Convention Deficiencies

None

Class Memoranda

Issued	Description of Memoranda
04 Jun 2010	Salt water ballast tank subject to annual examination: None
09 Jul 2014	Vessel to operate within Malaysian waters only
18 Jan 2018	As per Malaysia flag exemption letter issued on 07 July 2014. Vessel is exemption for the requirements SOLAS Chapter V, Regulation 20 - Voyage Data Recorder with condition vessel is restricted to operated within Malaysian water only.
27 May 2021	In accordance with MSN 14/2020, Vessel is in compliance with International Ballast Water Management Convention (D-1 standard) as vessel is solely engaged within Malaysia water. BWM Convention " Standard in reg. D-2 " Ballast Water Performance (treatment system) to be complied with if vessel is plying in international voyages.
27 May 2021	The service notation "SPECIAL SERVICE ", with additional service feature: "OFFSHORE MAINTENANCE VESSEL" was assigned.

Statutory Memoranda

None

Surveys / Audits / Inspections

Statutory Surveys

Survey name	Last	Due Date	Range (from, to)	Postponed	Status
Launching App. - Annual Test	S 15 Jun 2022	26 May 2023	26 Feb 2023 - 26 Aug 2023		Within window
Launching App. - Quinquennial Test	27 May 2021	26 May 2026	26 May 2026		
Dangerous Goods - Renewal	27 May 2021	26 May 2026	26 Feb 2026 - 26 May 2026		
Dangerous Goods - Annual	S 15 Jun 2022	26 May 2023	26 Feb 2023 - 26 Aug 2023		Within window
Oil Pollution - Renewal	27 May 2021	26 May 2026	26 Feb 2026 - 26 May 2026		
Oil Pollution - Annual	15 Jun 2022	26 May 2024	26 Feb 2024 - 26 Aug 2024		
Oil Pollution - Intermediate	S	26 May 2023	26 Feb 2023 - 26 Aug 2023		Within window
Sewage Pol - Renewal	27 May 2021	26 May 2026	26 Feb 2026 - 26 May 2026		
Garbage Renewal Survey	27 May 2021	26 May 2026	26 Feb 2026 - 26 May 2026		
Air Pollution - Renewal	27 May 2021	26 May 2026	26 Feb 2026 - 26 May 2026		
Air Pollution - Annual	15 Jun 2022	26 May 2024	26 Feb 2024 - 26 Aug 2024		
Air Pollution - Intermediate	S	26 May 2023	26 Feb 2023 - 26 Aug 2023		Within window
Ballast Water Mngt - Renewal	27 May 2021	26 May 2026	26 Feb 2026 - 26 May 2026		
Ballast Water Mngt - Annual	15 Jun 2022	26 May 2024	26 Feb 2024 - 26 Aug 2024		
Ballast Water Mngt - Intermediate	S	26 May 2023	26 Feb 2023 - 26 Aug 2023		Within window
ILO 152 Cargo Gear - Periodical	27 May 2021	26 May 2026	26 May 2026		
ILO 152 Cargo Gear - Annual	15 Jun 2022	15 Jun 2023	15 Jun 2023		Limit Date in less than 3 m.
Anti-Fouling System - Renewal	27 May 2021				

Statutory Audits / Inspections

Audit / Inspection name	Last	Due Date	Range (from, to)	Postponed	Status
ISM - Initial	30 Nov 2021				
ISM - Intermediate		29 May 2024	29 Nov 2023 - 29 Nov 2024		
ISM - Renewal		29 Nov 2026	29 Aug 2026 - 29 Nov 2026		
ISPS - Initial	30 Nov 2021				
ISPS - Intermediate		29 May 2024	29 Nov 2023 - 29 Nov 2024		
ISPS - Renewal		29 Nov 2026	29 Aug 2026 - 29 Nov 2026		
SSP approved or amended satisfactorily on 13 Mar 2014					
MLC Initial inspection	30 Nov 2021				DMLC II approved
MLC Intermediate inspection		29 May 2024	29 Nov 2023 - 29 Nov 2024		
MLC Renewal inspection		29 Nov 2026	29 Aug 2026 - 29 Nov 2026		
DMLC reviewed satisfactorily on 20 Mar 2018 & approved on 30 Nov 2021					

Legend:

- S Overdue
 S Overdue in less than 1 month
 S Within the range

Tests done by Service Suppliers

Test name	Last recorded
AIS annual test	15/6/2022
VDR annual test	00/00/0000
LSA annual test	15/06/2022
LSA renewal test	02/03/2021

Conditions of Class / Statutory Recommendations

None

Surveys / Audits / Inspections

Classification Surveys

Survey name	Last	Due Date	Range (from, to)	Postponed	Status
Hull - Renewal	27 May 2021	26 May 2026	26 Feb 2025 - 26 May 2026		
Hull - Annual for Renewal	27 May 2021	26 May 2026	26 Feb 2026 - 26 May 2026		
Hull - Annual	S 15 Jun 2022	26 May 2023	26 Feb 2023 - 26 Aug 2023		Within window
Annual survey of structure	S 15 Jun 2022	26 May 2023	26 Feb 2023 - 26 Aug 2023		Within window
Hull - Intermediate	S	26 Nov 2023	26 Feb 2023 - 26 Aug 2024		Within window
Bottom Survey in Dry Dock or afloat	27 May 2021	27 May 2024	27 May 2024		
Machinery - Renewal	27 May 2021	26 May 2026	26 Feb 2025 - 26 May 2026		
Machinery - Annual for Renewal	27 May 2021	26 May 2026	26 Feb 2026 - 26 May 2026		
Machinery - Annual	S 15 Jun 2022	26 May 2023	26 Feb 2023 - 26 Aug 2023		Within window
Portside Tailshaft Survey	27 May 2021	26 May 2026	26 May 2026		Last method: Method 1
Starboard Tailshaft Survey	27 May 2021	26 May 2026	26 May 2026		Last method: Method 1

Statutory Surveys

Survey name	Last	Due Date	Range (from, to)	Postponed	Status
Load Line - Renewal	27 May 2021	26 May 2026	26 Feb 2026 - 26 May 2026		
Load Line - Annual	S 15 Jun 2022	26 May 2023	26 Feb 2023 - 26 Aug 2023		Within window
Saf. Construction - Renewal	27 May 2021	26 May 2026	26 Feb 2025 - 26 May 2026		
Harmonized Safety Construction Annual Survey For R	27 May 2021	26 May 2026	26 Feb 2026 - 26 May 2026		
Saf. Construction - Annual	S 15 Jun 2022	26 May 2023	26 Feb 2023 - 26 Aug 2023		Within window
Saf. Construction - intermediate	S	26 May 2024	26 Feb 2023 - 26 Aug 2024		Within window
Saf. Equipment - Renewal	27 May 2021	26 May 2026	26 Feb 2026 - 26 May 2026		
Saf. Equipment - Annual	15 Jun 2022	26 May 2024	26 Feb 2024 - 26 Aug 2024		
Saf. Equipment - Periodical	S	26 May 2023	26 Feb 2023 - 26 Aug 2023		Within window
Launching Appliances - Annual Test	S 15 Jun 2022	26 May 2023	26 Feb 2023 - 26 Aug 2023		Within window
Launching App. - Quinquennial Test	27 May 2021	26 May 2026	26 May 2026		
Saf. Radio - Renewal	27 May 2021	26 May 2026	26 Feb 2026 - 26 May 2026		
Saf. Radio - Periodical	S 15 Jun 2022	26 May 2023	26 Feb 2023 - 26 Aug 2023		Within window
SPS 2008 <= 60p Safety Const. Renewal Survey	27 May 2021	26 May 2026	26 Feb 2025 - 26 May 2026		
SPS 2008 <= 60p Safety Const. Ann. Sur. For Ren.	27 May 2021	26 May 2026	26 Feb 2026 - 26 May 2026		
SPS 2008 <= 60p Safety Const. Annual Survey	S 15 Jun 2022	26 May 2023	26 Feb 2023 - 26 Aug 2023		Within window
SPS 2008 <= 60p Safety Const. Intermediate Surv.	S	26 May 2024	26 Feb 2023 - 26 Aug 2024		Within window
SPS 2008 <= 60p Safety Equipment Renewal Survey	27 May 2021	26 May 2026	26 Feb 2026 - 26 May 2026		
SPS 2008 <= 60p Safety Equipment Annual Survey	15 Jun 2022	26 May 2024	26 Feb 2024 - 26 Aug 2024		
SPS 2008 <= 60p Safety Equip. Periodical Survey	S	26 May 2023	26 Feb 2023 - 26 Aug 2023		Within window
SPS 2008 <= 60p Safety Radio Renewal Survey	27 May 2021	26 May 2026	26 Feb 2026 - 26 May 2026		
SPS 2008 <= 60p Safety Radio Periodical Survey	S 15 Jun 2022	26 May 2023	26 Feb 2023 - 26 Aug 2023		Within window

Legend:

S Overdue
 S Overdue in less than 1 month
 S Within the range

Conditions of Class / Statutory, ISM, ISPS, MLC Status

The Conditions of Class / Statutory, ISM, ISPS, MLC Status below shows the information available in VeriSTAR Info database at the time the report is printed. This may not indicate certificates issued, surveys carried out or conditions of class / recommendations issued but not yet reported to BV Head Office.

Classification

Status: Active

Certificates

Certificate name	Issued	Expiry	Extended	Type	Status
Classification					
Class Certificate	07 Sep 2021	26 May 2026		Definitive	
Load line					
Load Line Certificate	07 Sep 2021	26 May 2026		Definitive	
SOLAS					
Safety Construction Certificate	07 Sep 2021	26 May 2026		Definitive	
Safety Equipment Certificate	07 Sep 2021	26 May 2026		Definitive	
SOLAS Safety Equipment Harmonized exemption issued on 07 Sep 2021, for the following provisions: from the requirements of SOLAS Reg III / 32.3 (Immersion Suits) of the Convention.					
Safety Radio Certificate	07 Sep 2021	26 May 2026		Definitive	
Dangerous goods DoC	07 Sep 2021	26 May 2026		Definitive	
IMO Codes					
SPS 2008 <=60 persons	07 Sep 2021	26 May 2026		Definitive	
MARPOL					
Oil Pollution Prevention Certif	07 Sep 2021	26 May 2026		Definitive	
Sewage Pollution Prevention Certif	07 Sep 2021	26 May 2026		Definitive	
Garbage Pollution Prevention SoC	08 Sep 2021	26 May 2026		Definitive	
Air Pollution Prevention Certif	07 Sep 2021	26 May 2026		Definitive	
BWM convention					
Ballast Water Management Certif.	07 Sep 2021	26 May 2026		Definitive	
ILO 152					
ILO 152 Cargo Gear	27 May 2021			Definitive	
AFS convention					
Anti-Fouling System Certificate	27 May 2021			Definitive	
ISM Code					
Safety Management Certificate	22 Dec 2021	29 Nov 2026		Definitive	
ISPS Code					
Ship Security Certificate	22 Dec 2021	29 Nov 2026		Definitive	
MLC Code					
MLC Certificate	22 Dec 2021	29 Nov 2026		Definitive	

Legend:

■ Expired ■ Expires in less than 1 month ■ Expires in less than 3 months

Exemptions

Exemption name	Issued date	Exempted from	Conditions	Voyages
SOLAS Safety Equipment Harmonized exemption	07 Sep 2021	from the requirements of SOLAS Reg III / 32.3 (Immersion Suits) of the Convention.	-	Valid for the Voyages within the latitude of 30 Deg North and 30 Deg South

Cargo & Ballast Capacities

Ballast Tanks

Tank/Hold Identification	Initial Frame	Final Frame	Position	Last survey	Job Number	Protection	Coating Cond.	Annual Exam.
W.B. FP. TK. (C)	109	118	Centre	27 May 2021	MIR0/2020/J5192	Hard coated	Good	No
NO.1 D.W./W.B. DB. TK. (S)	84	99	Starboard	27 May 2021	MIR0/2020/J5192	Hard coated	Good	No
NO.1 D.W./W.B. DB. TK. (P)	84	99	Portside	27 May 2021	MIR0/2020/J5192	Hard coated	Good	No
NO.2 D.W./W.B. TK. (S)	67	84	Starboard	27 May 2021	MIR0/2020/J5192	Hard coated	Good	No
NO.2 D.W./W.B. TK. (P)	67	84	Portside	27 May 2021	MIR0/2020/J5192	Hard coated	Good	No
NO.3 D.W./W.B. TK. (P)	55	67	Portside	27 May 2021	MIR0/2020/J5192	Hard coated	Good	No
NO.3 D.W./W.B. TK. (S)	55	67	Starboard	27 May 2021	MIR0/2020/J5192	Hard coated	Good	No
NO.5 D.W./W.B. TK. (S)	38	55	Starboard	27 May 2021	MIR0/2020/J5192	Hard coated	Good	No
NO.5 D.W./W.B. TK. (P)	38	55	Portside	27 May 2021	MIR0/2020/J5192	Hard coated	Good	No
NO.4 D.W./W.B. DB. TK. (S)	38	55	Starboard	27 May 2021	MIR0/2020/J5192	Hard coated	Good	No
NO.4 D.W./W.B. DB. TK. (P)	38	55	Portside	27 May 2021	MIR0/2020/J5192	Hard coated	Good	No
NO.7 D.W./W.B. TK. (S)	28	38	Starboard	27 May 2021	MIR0/2020/J5192	Hard coated	Good	No
NO.7 D.W./W.B. TK. (P)	28	38	Portside	27 May 2021	MIR0/2020/J5192	Hard coated	Good	No
NO.6 D.W./W.B. DB. TK. (S)	23	38	Starboard	27 May 2021	MIR0/2020/J5192	Hard coated	Good	No
NO.6 D.W./W.B. DB. TK. (P)	23	38	Portside	27 May 2021	MIR0/2020/J5192	Hard coated	Good	No
NO.8 D.W./W.B. DB. TK. (S)	9	23	Starboard	27 May 2021	MIR0/2020/J5192	Hard coated	Good	No
NO.8 D.W./W.B. DB. TK. (P)	9	23	Portside	27 May 2021	MIR0/2020/J5192	Hard coated	Good	No
NO.9 D.W./W.B. TK. (S)	9	28	Starboard	27 May 2021	MIR0/2020/J5192	Hard coated	Good	No
NO.9 D.W./W.B. TK. (P)	9	28	Portside	27 May 2021	MIR0/2020/J5192	Hard coated	Good	No
NO.10 D.W./W.B. WING TK. (S)	-6	7	Starboard	27 May 2021	MIR0/2020/J5192	Hard coated	Good	No
NO.10 D.W./W.B. WING TK. (P)	-6	7	Portside	27 May 2021	MIR0/2020/J5192	Hard coated	Good	No
W.B. AP TK. (S)	-6	-2	Starboard	27 May 2021	MIR0/2020/J5192	Hard coated	Good	No
W.B. AP TK. (P)	-6	-2	Portside	27 May 2021	MIR0/2020/J5192	Hard coated	Good	No

Cargo Tanks

Tank/Hold Identification	Initial Frame	Final Frame	Position	Last survey	Job Number
NO.1 MUD TK. (S)	28	38	Starboard	27 May 2021	MIR0/2020/J5192
NO.1 MUD TK. (P)	28	38	Portside	27 May 2021	MIR0/2020/J5192
NO.2 MUD TK. (S)	18	28	Starboard	27 May 2021	MIR0/2020/J5192
NO.2 MUD TK. (P)	18	28	Portside	27 May 2021	MIR0/2020/J5192

Ship Particulars

Identification

Ship Type: Special service
System Ship Type: Other cargo ship

Classification

Class Symbols: I Hull Mach
Service Notations: Fire-fighting Special service Offshore Maintenance Vessel
Navigation Not.: Unrestricted navigation
Machinery: MACH
Equipment: 2 Main anchors, chain diameter 48 mm, steel quality Q2 (High tensile strength steel)

Hull

Gross Tonnage 69:	3404	Builder:	Nantong Tongbao Shipbuilding Co.Ltd.
Net Tonnage 69:	1125	Date of build:	20 Oct 2009
Deadweight:	2161 ton	Hull Material:	Steel
Overall Length:	78 m	Hull Info:	Single Hull
LPP:	70.55 m		7 watertight compartments
Breadth:	20 m		1 continuous deck(s)
Depth:	6.5 m	Survey Type:	Normal (Hull)
Draught:	4.82 m		
Freeboard:	1312 mm		

Machinery

Propelling type:	Diesel	Elec. installation:	3 Generators
Total power:	3840 kW (5218 HP)		937 kVA (750 kW), 415 V, 50 Hz
Propelling machinery:	2 Yanmar 6EY26	Thruster(s):	1 forward thruster 680 kW
	4T, 6 cyl, 750 rpm	Survey Type:	Normal
Builder:	YANMAR CO., LTD		
Propeller:	2 Solid Screw Propeller LB (oil -closed) 5, 250 rpm		
Auxiliary Engine(s):	3 Diesel (2640Kw/3588HP)		
Emergency Engine(s):			

Table of Contents

- Ship Particulars
- Owner / Manager Information
- Cargo & Ballast Capacities
- Conditions of Class / Statutory, ISM, ISPS, MLC Status
- Planned Inspection Items
- 1-Year Survey Planner
- Regulatory Information
- Bureau Veritas Contacts

The latest published Rules of the Bureau Veritas Marine & Offshore and the Terms of use are applicable
La dernière édition des règlements de Bureau Veritas Marine & Offshore ainsi que les Conditions Générales d'utilisation sont applicables

Any person not a party to the contract pursuant to which this document is delivered may not assert a claim against Bureau Veritas for any liability arising out of errors or omissions which may be contained in said document, or for errors of judgement, fault or negligence committed by personnel of the Society or of its Agents in the establishment or issuance of this document, and in connections with any activities for which it may provide.

Extract of Rules Pt A, Ch 2, Sec 2, [3.4]

3.4.1 - Information given in the Certificate of Classification, associated endorsements, Rules and specific documents enables the Owner to identify the status of surveys and Conditions of Class/recommendations.

3.4.2 - The omission of such information does not absolve the Owner from ensuring that surveys are held by the limit dates and pending Conditions of Class/recommendations are cleared to avoid any inconvenience which is liable to result from the suspension or withdrawal of class; see Ch 2, Sec 3.

Toute personne qui n'est pas partie au contrat aux termes duquel ce document est délivré ne pourra engager la responsabilité du Bureau Veritas pour les inexactitudes ou omissions qui pourrait y être relevées ainsi que les erreurs de jugement, fautes ou négligences commises par le personnel de la Société ou par ses agents dans l'établissement de ce document et dans l'exécution des interventions qu'il comporte.

Extrait du Règlement Pt A, Ch 2, Sec 2, [3.4]

3.4.1 - Les informations données dans le Certificat de Classification, les endorsements associés, le Règlement et les documents spécifiques au navire permettent à l'Armateur d'identifier la situation des visites et des réserves.

3.4.2 - L'omission de ces informations ne décharge pas l'Armateur de s'assurer que les visites sont effectuées aux dates limites et que les réserves en suspens sont levées, afin d'éviter les inconvénients pouvant résulter de la suspension ou du retrait de la classe; voir Ch 2, Sec 3.